

Tectite ADVANCE

The Carbon Steel Push-fit System



Tectite

ADVANCE

The Carbon Steel Push-fit System

Tectite Advance is our latest innovative push-fit System. It will revolutionise your approach to vented and unvented closed circuit heating and chilled water installations.



- ***The first galvanised carbon steel push-fit jointing System***
- ***Fittings and carbon steel System tube available in sizes from 15mm to 54mm***
- ***Low profile, compact design providing electrical continuity***
- ***Installed cost savings of up to 70% when compared to traditional jointing methods***
- ***10 year System guarantee***
- ***No special tools or time consuming threading required***

Designed for use as a System in conjunction with our galvanised and plastic coated XPress Carbon steel System tube, our research shows that a Tectite Advance System is five times quicker to install than a traditional screwed steel installation.*

With installed cost savings of up to 70% borne out in an independent industry report, Tectite Advance will help deliver your projects on time and within budget.

*Research carried out in conjunction with Leeds College of Building, February 2007.

Installation instructions

To ensure Tectite Advance fittings stay clean and free from damage, only remove the fitting from its packaging immediately prior to installation.

Preliminaries

Select the right size of tube and fitting. Ensure both are clean and free from damage, scores and imperfections, and that the “O” ring and grab ring are clean and intact within the fitting. Do not use any additional lubricant or sealing compounds.

Preparation



1. Cut the tube square using a cutting tool such as the Rems Cento, or a rotary tube cutter.



2. When using plastic coated XPress Carbon steel System tube, the coating must be removed to the socket depth of the

fitting using the S115 stripping tool from the XPress accessories range. Select the correct sized tool, fully insert the tube and twist the tool until the excess of plastic is completely detached.



3. Remove any burrs or sharp edges from the external tube end using an S120 deburring tool from the XPress accessories range. Also deburr the internal bore.

If using plastic coated tube, the use of the S115 tool (as Point 2), will deburr the inside of 15mm to 28mm tube. The same tool will also deburr the outside of plastic coated tube – insert the tube into the opposite end of the tool and twist.

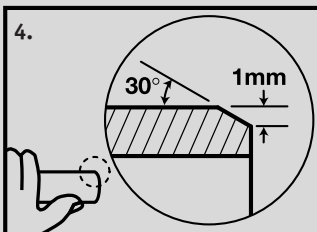

4. Having deburred as above you will be left with a 1mm chamfer on the outside of the tube, as indicated in the diagram. Wipe clean the

tube end to remove all swarf and debris.



5. Mark the socket depth using a marker/pencil and the T117 depth gauge or with a ruler to the correct depth (see table).

Joining



1. Inspect the fitting ensuring that the grab rings/'O'-rings have not been contaminated with grit or debris. Insert the tube/pipe into the mouth of the fitting to rest against the grab ring.



2. Push the tube firmly with a slight twisting action until it reaches the tube stop with a positive “click”.



3. Ensure the depth insertion mark corresponds with the mouth of the fitting, then pull firmly on the tube to ensure the fitting is secure.

Tectite Advance fitting socket depths

| Size | Socket depth |
|------|--------------|
| 15mm | 18mm |
| 18mm | 18mm |
| 22mm | 19mm |
| 28mm | 20mm |
| 35mm | 31mm |
| 42mm | 32mm |
| 54mm | 37mm |

NOTE: Tectite Advance fittings must not be used with male ended fittings or valves from other Tectite ranges (Except T526S).

Other third party male-ended products should not be used with Tectite Sprint.

Do not use Tectite Advance on gas services

Tectite Advance Fittings are non-demountable.

System Performance

Working temperatures and pressures

A Tectite Advance System performs to the following working temperatures and pressures.

Tectite Advance performance when correctly assembled with carbon steel tube to DIN 2394/NEN 1982

| Sizes | Service Temperature | | | Max 114°C |
|--------------|---------------------|--------|--------|--------------|
| | Min -24°C | 30°C | 65°C | |
| 15mm to 54mm | 20 bar | 20 bar | 16 bar | 10 bar |

Tube compatibility

Tectite Advance fittings are designed to be used with our galvanised and plastic coated XPress Carbon steel System tube to DIN 2394/NEN 1982.

They can also be used with other thin-walled carbon steel tubes meeting this specification.



Guarantees

Tectite Advance fittings are guaranteed for 5 years against manufacturing defects.

When used in a System exclusively with our XPress Carbon steel System tube, a guarantee of 10 years applies.

To qualify for these guarantees, products must be installed in accordance with our instructions on specified applications.

Specification clauses

The following specification clauses provide the exact wording required to ensure the correct Tectite product is used for the job.

Tectite Advance fitting specification

“Push-fit fittings shall be made from carbon steel in sizes from 15mm to 54mm, they will be capable of operating between -24°C and 114°C. With a pressure rating of 20 bar from -24°C to 30°C, 16 bar from 31°C to 65°C and of 10 bar from 66°C to 114°C. Suitable for use on unvented closed circuit heating and chilled water applications, with galvanised or plastic coated XPress carbon steel System tube to DIN 2394/NEN 1982 or other carbon steel tube to DIN 2394/NEN 1982. Fittings shall provide electrical continuity when installed with carbon steel tube and will have a guarantee of 5 years against all manufacturing defects and be drawn from the Tectite Advance range from Pegler Yorkshire.

Tectite Advance System specification

“Push-fit fittings shall be made from carbon steel in sizes from 15mm to 54mm, they will be capable of operating between -24°C and 114°C. With a pressure rating of 20 bar from -24°C to 30°C, 16 bar from 31°C to 65°C and of 10 bar from 66°C to 114°C. Suitable for use on unvented closed circuit heating and chilled water applications, Fittings shall provide electrical continuity when installed with carbon steel tube and be drawn from the Tectite Advance range from Pegler Yorkshire. Tubes shall be galvanised/ plastic coated XPress carbon steel System tube to DIN 2394/NEN 1982 drawn from the XPress Carbon range from Pegler Yorkshire. The system will be constructed exclusively with components from the Tectite Advance and XPress Carbon ranges from Pegler Yorkshire and have a guarantee of 10 years against all manufacturing defects”.

Carbon Steel System Tube

SC640 – Galvanised Carbon Steel System Tube

3 meter lengths

| SIZE | MTR | CODE |
|--------------|-----|-------|
| 15mm x 1.2mm | 3m | 45080 |
| 18mm x 1.2mm | 3m | 45081 |
| 22mm x 1.5mm | 3m | 45082 |
| 28mm x 1.5mm | 3m | 45083 |
| 35mm x 1.5mm | 3m | 45084 |
| 42mm x 1.5mm | 3m | 45085 |
| 54mm x 1.5mm | 3m | 45086 |

SC640 – Galvanised Carbon Steel System Tube

6 meter lengths

| SIZE | MTR | CODE |
|--------------|-----|-------|
| 15mm x 1.2mm | 6m | 25080 |
| 18mm x 1.2mm | 6m | 25081 |
| 22mm x 1.5mm | 6m | 25082 |
| 28mm x 1.5mm | 6m | 25083 |
| 35mm x 1.5mm | 6m | 25084 |
| 42mm x 1.5mm | 6m | 25085 |
| 54mm x 1.5mm | 6m | 25086 |

SC660 – Plastic Coated Galvanised Carbon Steel System Tube

6 meter lengths

| SIZE | MTR | CODE |
|--------------|-----|-------|
| 15mm x 2.2mm | 6m | 25060 |
| 18mm x 2.2mm | 6m | 25061 |
| 22mm x 2.5mm | 6m | 25062 |
| 28mm x 2.5mm | 6m | 25063 |
| 35mm x 2.5mm | 6m | 25064 |
| 42mm x 2.5mm | 6m | 25065 |
| 54mm x 2.5mm | 6m | 25066 |

Tectite Advance push-fit fittings

TA1 Straight coupling



| SIZE | BOX QTY | CODE |
|------|---------|-------|
| 15mm | 10 | 76000 |
| 18mm | 10 | 76001 |
| 22mm | 5 | 76002 |
| 28mm | 5 | 76003 |
| 35mm | 5 | 76004 |
| 42mm | 1 | 76005 |
| 54mm | 1 | 76006 |

TA2 Straight female connector



| SIZE | BOX QTY | CODE |
|-------------|---------|-------|
| 15mm x 1/2" | 10 | 76007 |
| 18mm x 1/2" | 10 | 76008 |
| 22mm x 3/4" | 5 | 76010 |
| 28mm x 1" | 5 | 76011 |

TA3 Straight male connector



| SIZE | BOX QTY | CODE |
|---------------|---------|-------|
| 15mm x 1/2" | 10 | 76013 |
| 18mm x 1/2" | 10 | 76014 |
| 22mm x 3/4" | 5 | 76016 |
| 28mm x 1" | 5 | 76017 |
| 35mm x 1 1/4" | 5 | 76018 |
| 42mm x 1 1/4" | 1 | 76019 |
| 54mm x 2" | 1 | 76020 |

TA6 Reducer



| SIZE | BOX QTY | CODE |
|-----------|---------|-------|
| 18 x 15mm | 10 | 76021 |
| 22 x 15mm | 5 | 76022 |
| 22 x 18mm | 5 | 76023 |
| 28 x 15mm | 5 | 76024 |
| 28 x 18mm | 5 | 76025 |
| 28 x 22mm | 5 | 76026 |
| 35 x 15mm | 5 | 76110 |
| 35 x 18mm | 5 | 76111 |
| 35 x 22mm | 5 | 76027 |
| 35 x 28mm | 5 | 76028 |
| 42 x 22mm | 1 | 76112 |
| 42 x 28mm | 1 | 76113 |
| 42 x 35mm | 1 | 76029 |
| 54 x 22mm | 1 | 76030 |
| 54 x 28mm | 1 | 76031 |
| 54 x 35mm | 1 | 76114 |
| 54 x 42mm | 1 | 76032 |

TA12 Elbow



| SIZE | BOX QTY | CODE |
|------|---------|-------|
| 15mm | 10 | 76033 |
| 18mm | 10 | 76034 |
| 22mm | 5 | 76035 |
| 28mm | 5 | 76036 |
| 35mm | 5 | 76037 |
| 42mm | 1 | 76038 |
| 54mm | 1 | 76039 |

TA12S Street Elbow

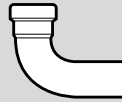

| SIZE | BOX QTY | CODE |
|------|---------|-------|
| 15mm | 10 | 76040 |
| 18mm | 10 | 76041 |
| 22mm | 5 | 76042 |
| 28mm | 5 | 76043 |
| 35mm | 5 | 76044 |
| 42mm | 1 | 76045 |
| 54mm | 1 | 76046 |

TA12S Street Elbow



| SIZE | BOX QTY | CODE |
|------|---------|-------|
| 15mm | 10 | 76047 |
| 18mm | 10 | 76048 |
| 22mm | 5 | 76049 |
| 28mm | 5 | 76050 |
| 35mm | 5 | 76051 |
| 42mm | 1 | 76052 |
| 54mm | 1 | 76053 |

TA12S Street Elbow



| SIZE | BOX QTY | CODE |
|------|---------|-------|
| 15mm | 10 | 76054 |
| 18mm | 10 | 76055 |
| 22mm | 5 | 76056 |
| 28mm | 5 | 76057 |
| 35mm | 5 | 76058 |
| 42mm | 1 | 76059 |
| 54mm | 1 | 76060 |

TA24 Equal tee

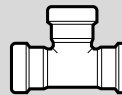

| SIZE | BOX QTY | CODE |
|------|---------|-------|
| 15mm | 10 | 76061 |
| 18mm | 10 | 76062 |
| 22mm | 5 | 76063 |
| 28mm | 2 | 76064 |
| 35mm | 5 | 76065 |
| 42mm | 1 | 76066 |
| 54mm | 1 | 76067 |

TA25 Tee, reduced branch

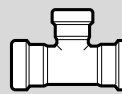

| SIZE | BOX QTY | CODE |
|----------------|---------|-------|
| 18 x 18 x 15mm | 10 | 76068 |
| 22 x 22 x 15mm | 5 | 76069 |
| 22 x 22 x 18mm | 5 | 76070 |
| 28 x 28 x 15mm | 2 | 76071 |
| 28 x 28 x 18mm | 2 | 76072 |
| 28 x 28 x 22mm | 2 | 76073 |
| 35 x 35 x 15mm | 5 | 76074 |
| 35 x 35 x 18mm | 5 | 76075 |
| 35 x 35 x 22mm | 5 | 76076 |
| 35 x 35 x 28mm | 5 | 76077 |
| 42 x 42 x 22mm | 1 | 76078 |
| 42 x 42 x 28mm | 1 | 76079 |
| 42 x 42 x 35mm | 1 | 76080 |
| 54 x 54 x 22mm | 1 | 76081 |
| 54 x 54 x 28mm | 1 | 76082 |
| 54 x 54 x 35mm | 1 | 76083 |
| 54 x 54 x 42mm | 1 | 76084 |

TA30 Female Branch Tee

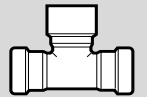

| SIZE | BOX QTY | CODE |
|------------------|---------|-------|
| 15 x 15mm x 1/2" | 10 | 76085 |
| 18 x 18mm x 1/2" | 10 | 76086 |
| 22 x 22mm x 1/2" | 5 | 76087 |
| 28 x 28mm x 1/2" | 2 | 76088 |
| 35 x 35mm x 1/2" | 1 | 76089 |
| 42 x 42mm x 1/2" | 1 | 76090 |
| 54 x 54mm x 1/2" | 1 | 76091 |

TS6 Stop End



| SIZE | BOX QTY | CODE |
|------|---------|-------|
| 15mm | 10 | 25866 |
| 18mm | 5 | 25870 |
| 22mm | 5 | 25874 |
| 28mm | 5 | 25876 |
| 35mm | 1 | 25878 |
| 42mm | 1 | 25880 |
| 54mm | 1 | 25882 |

TA69 Straight Male Union Connector

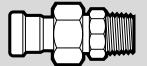

| SIZE | BOX QTY | CODE |
|---------------|---------|-------|
| 15mm x 1/2" | 10 | 76092 |
| 18mm x 1/2" | 10 | 76094 |
| 22mm x 3/4" | 5 | 76097 |
| 28mm x 1" | 2 | 76099 |
| 35mm x 1 1/4" | 5 | 76100 |
| 42mm x 1 1/4" | 1 | 76101 |
| 54mm x 2" | 1 | 76102 |

Accessories

T117 Depth Gauge



| SIZE | BOX QTY | CODE |
|------------|---------|-------|
| 15 to 54mm | 1 | 76120 |

S115 Tube stripper



| SIZE | BOX QTY | CODE |
|------------|---------|-------|
| 15mm | 1 | 39260 |
| 18mm | 1 | 39261 |
| 22mm | 1 | 39262 |
| 28mm | 1 | 39263 |
| 35 to 54mm | 1 | 39264 |

S120 Deburring tool



| SIZE | BOX QTY | CODE |
|------------|---------|-------|
| 15 to 54mm | 1 | 39168 |



The perfect commercial partnership



Pegler is an expert in the production of Taps, Mixers and Valve products. It boasts an unrivalled track record for integrity, quality, reliability and innovation.



Yorkshire is a specialist in the production of metal plumbing and heating fittings. It has an established reputation for manufacturing quality products.



Tectite ADVANCE

The Carbon Steel Push-fit System

For further information, please contact your appropriate Sales Office

UK

Telephone: 0113 270 6945 / 0113 272 5380
 Fax: 0113 270 5644 / 0113 272 5385
 Email: yorkshire.sales@peglyorkshire.co.uk

Northern Ireland

Telephone: 028 9070 6990
 Fax: 028 9070 6999
 Email: belfast.sales@peglyorkshire.co.uk

EXPORT

Telephone: +44 (0) 1302 560 330
 Fax: +44 (0) 1302 730 513
 Email: export@peglyorkshire.co.uk

Technical Support

Telephone: 0113 270 6945
 Fax: 0113 270 5644
 Email: yorkshiretech.help@peglyorkshire.co.uk



Yorkshire

Yorkshire Fittings Limited, Haigh Park Road, Stourton, Leeds, West Yorkshire, LS10 1RT, England.

www.peglyorkshire.co.uk

Registered Company No. 00401507. Place of Registration: England
 All brand names and logo styles are registered trademarks.

Maintaining a policy of continual product development, Pegler Yorkshire reserve the right to change specifications, design and materials of products listed in this price list without prior notice. LIT.REF: 880297 04.08